

## Proposed Improvements Exhibit

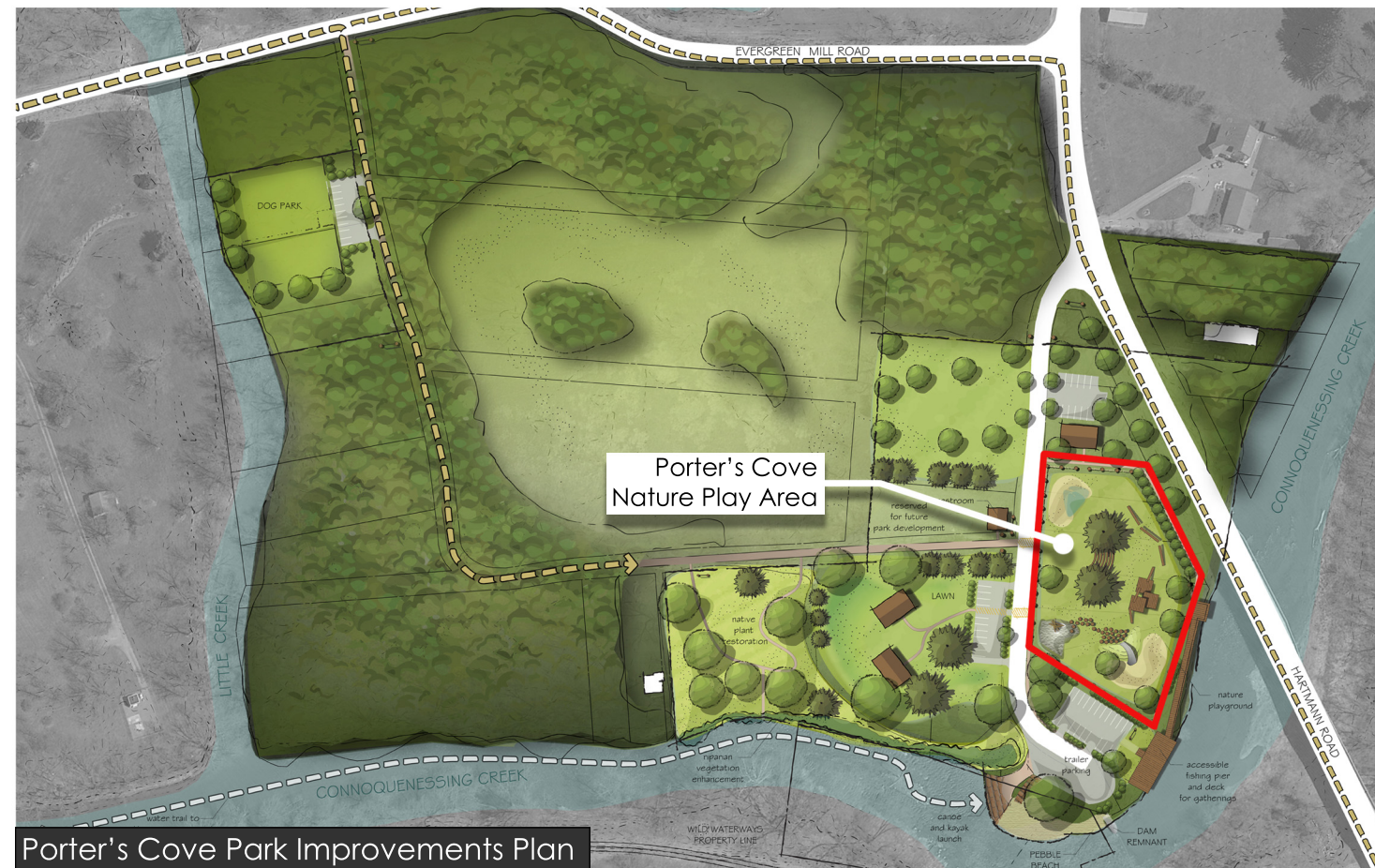

Porter's Cove Park Improvements Plan

### Nature Play Area Improvements Include:

- Newly constructed asphalt parking area with handicap accessible parking spaces and signage
- Asphalt walking trail throughout and surrounding the Nature Play Area
- Bollards and fencing surrounding the Play Area
- Nature Play elements throughout
- Amphitheater design
- Site Amenities such as benches, picnic tables, and litter receptacles
- Stormwater Management
- Landscape Improvements
- Park signage

**Porter's Cove Park | Nature Play Area**  
Jackson Township  
Butler County, Pennsylvania

HERBERT, ROWLAND & GRUBIC, INC.  
220 West Kensington Drive, Suite 100  
Cranberry Township, PA 16066  
W: 724.779.4777

**HRG**  
Herbert, Rowland & Grubic, Inc.  
Engineering & Related Services  
AN EMPLOYEE-OWNED COMPANY