

## Proposed Improvements Exhibit

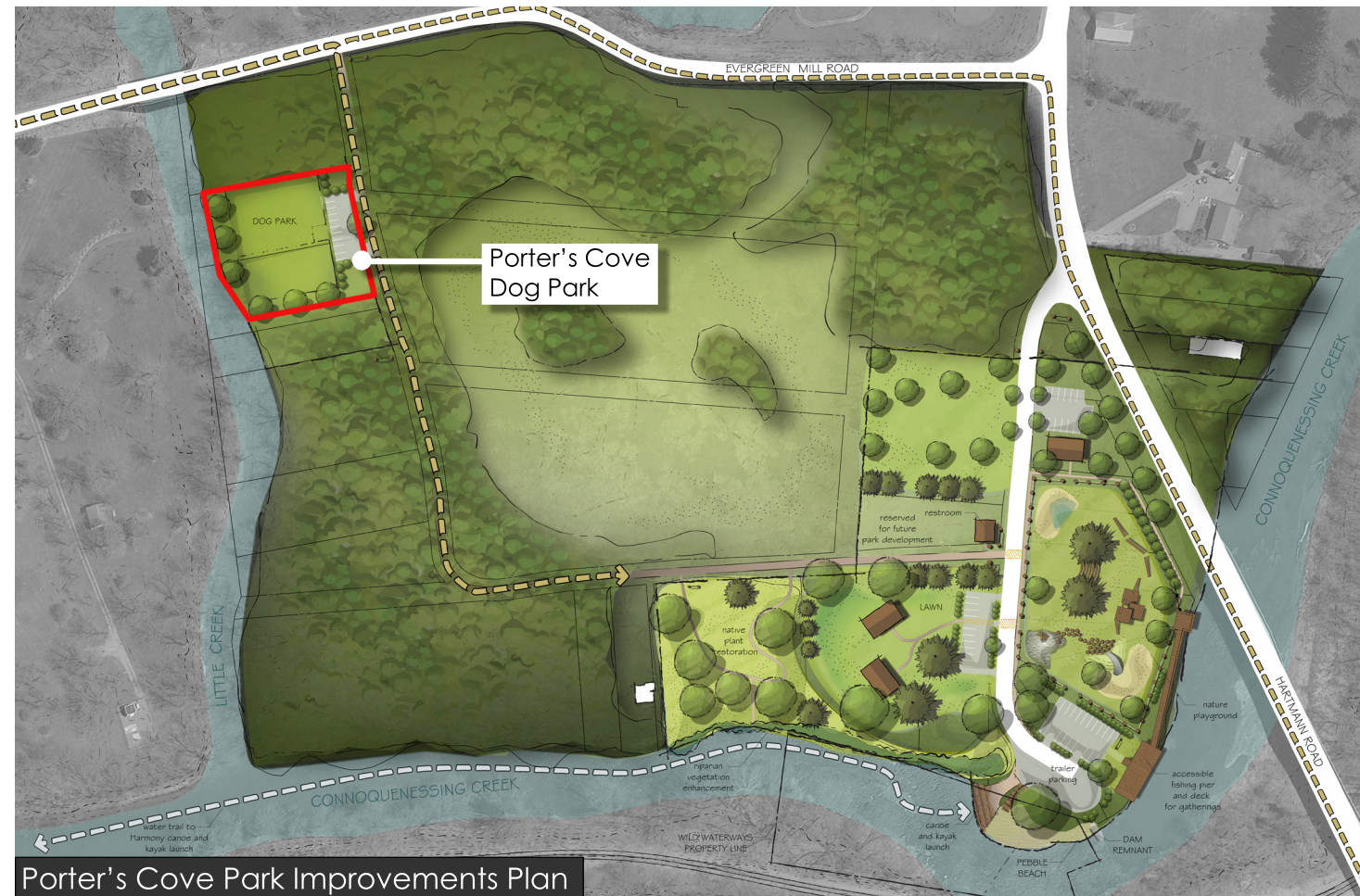

## Park Improvements Include:

- Newly constructed entry road off of Evergreen Mill Road
- Asphalt parking area with handicap accessible parking spaces and signage
- New fencing surrounding the park
- Fence for dog transitional safety area into and out of dog run area.
- Site Amenities such as benches, picnic tables, dog waste stations and litter receptacles
- Improved landscaping
- Park signage



Porter's Cove Park Improvements Plan



Porter's Cove Park- Location Map

**Porter's Cove Park | Dog Park**  
Jackson Township  
Butler County, Pennsylvania

HERBERT, ROWLAND & GRUBIC, INC.  
220 West Kensington Drive, Suite 100  
Cranberry Township, PA 16066  
WI: 724.779.4777

**HRG**  
Herbert, Rowland & Grubic, Inc.  
Engineering & Related Services  
AN EMPLOYEE-OWNED COMPANY